

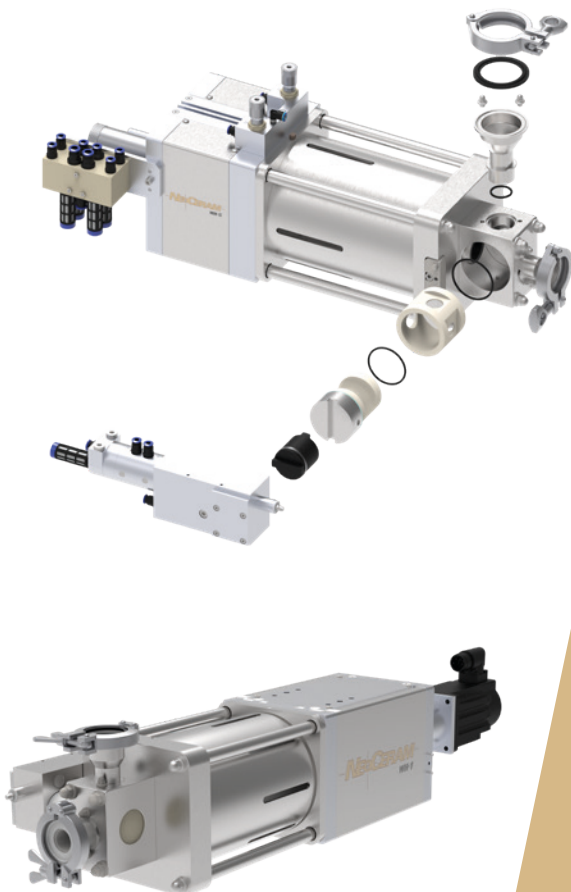

WH-5R Rotary valve pump



New NeocerAM WH-5 pumps, rotary valve version. These pumps are ideal for products with high and medium viscosity. Their modular design make these pumps easy to integrate with automated filling equipment.

- Volume up to 2 L
- Filling accuracy of up to $\pm 1/2$ % or better
- Pumps actuated pneumatically or by servo motor.
- Adjustment of filling volume and speed control by a precise built-in micrometer, for pneumatic pump drive type.
- Ceramic rotary valve for high viscous products up to 100,000 cps. Higher viscosities achievable with a pressurized inlet line/feeding system.
- Applications: Cosmetics, food, pharmaceutical, home care and more
- Reed switch ready design for accurate position feedback



Scan to visit
www.neoceramavanti.com



BQA_EMS_C_2023162



BQA_QMS_C_1997162

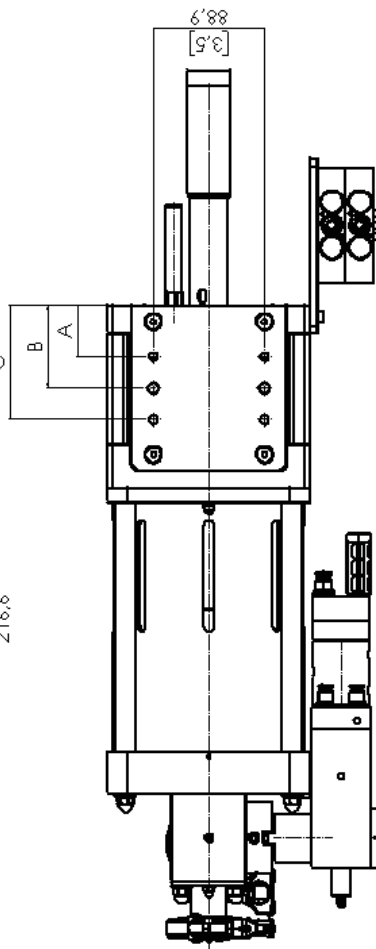
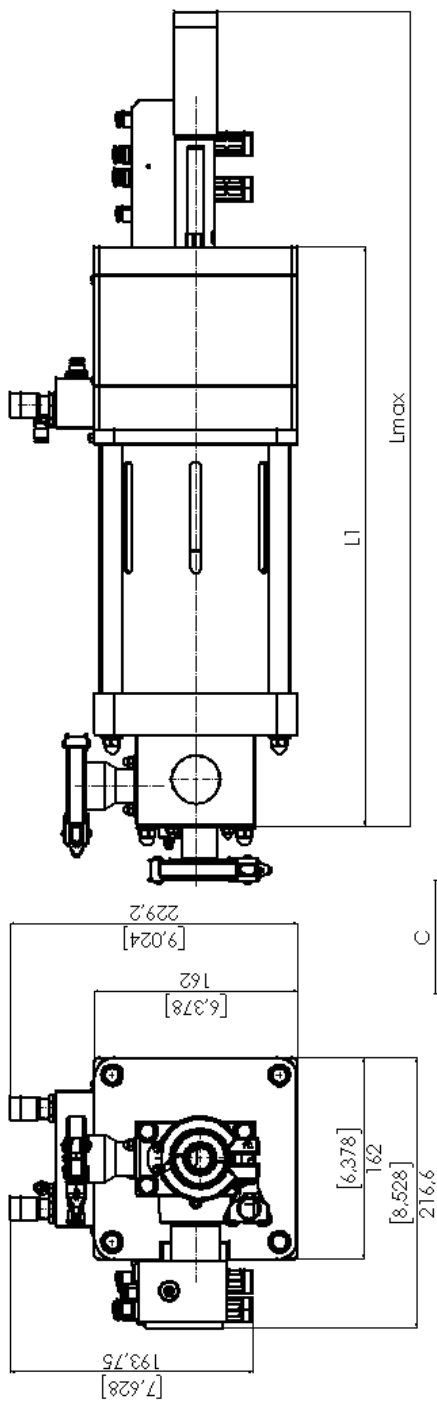

Model*	Plunger diameter inches (mm)	Dispensing stroke inches (mm)	Maximum dispensing volume (ml)	Air consumption scfm (l/min)**	Maximum cycle speed cpm***	Pump dimension **** inches (mm)				Pump length L inches (mm)	
						A	B	C	L	L min	L max
WH-5P3-R90xxxT	2-3/4 (69.85)	3 (76.2)	290	11.5 (325)	0 - 30	1.60 (40.78)	2.596 (65.959)	3.591 (91.2)	18.224 (462.9)	22.642 (575.1)	25.642 (651.3)
WH-5P3-R90xxxV	3-3/4 (95.25)	3 (76.2)	500	11.5 (325)	0 - 30	1.60 (40.78)	2.596 (65.959)	3.591 (91.2)	18.224 (462.9)	22.642 (575.1)	25.642 (651.3)
WH-5P3-R90xxxY	5-1/8 (130.18)	3 (76.2)	1000	11.5 (325)	0 - 30	1.60 (40.78)	2.596 (65.959)	3.591 (91.2)	18.224 (462.9)	22.642 (575.1)	25.642 (651.3)
WH-5P6-R90xxxZ	5-1/8 (130.18)	6 (152.4)	2000	9.5 (269)	0 - 12	4.598 (116.8)	5.593 (142.05)	6.587 (167.3)	21.22 (539)	25.638 (651.29)	28.704 (729.07)

* Model numbers listed are for illustrative purposes of the pneumatic version. Servo driven version also available. For full pump models, please contact a Neoceram sales representative.

** Air consumption values are indicative. These can vary depending on product characteristics and working conditions. This does not apply to servo drive type pumps.

*** Cycle speeds are indicative. These can vary depending on product characteristics and working conditions, as well as pump drive type.

**** The pump length for a servo motor will be different from the above dimensions.

North America

4525 Lehigh Drive

Walnutport, PA 18088 • USA

+1 (610) 837-9001

sales.avanti@neoceram.com

www.neoceramavanti.com



Europe

Viale dell' Agricoltura 12

15067 Novi Ligure (AL) • Italy

+39 0143 78538

sales.avanti.eu@neoceram.com